



SPECTRUMDNA™
A Division of SPECTRUM SOLUTIONS, LLC

**STEP BY STEP INSTRUCTION ON PROPER COLLECTION OF SALIVA SAMPLE
FOR COVID-19 TESTING**



DO NOT EAT, DRINK, CHEW GUM, OR USE ANY TYPE OF TOBACCO PRODUCTS 30 MINUTES BEFORE GIVING THE SALIVA SAMPLE.

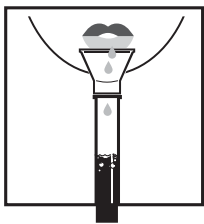

STEP 1: FILL THE TUBE WITH SALIVA TO THE BLACK WAVY LINE.

FILL THE TUBE UNTIL YOUR SALIVA (NOT INCLUDING BUBBLES) IS AT OR JUST ABOVE THE WAVY LINE. DO NOT OVERFILL or BRING ANY PHLEGM OR SPUTUM FROM THE BACK OF THE THROAT,

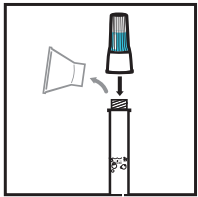

STEP 2: REPLACE THE FUNNEL WITH FLUID CAP.

REMOVE THE FUNNEL FROM THE TUBE. SCREW ON THE ENCLOSED CAP TIGHTLY TO RELEASE THE SOLUTION THAT WILL STABILIZE THE DNA IN YOUR SALIVA.

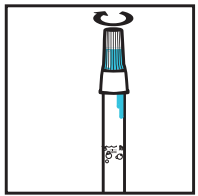

STEP 3: FIRMLY SCREW CAP DOWN TO RELEASE SOLUTION AND SEAL TUBE.

YOU WILL KNOW IT WORKS WHEN THE BLUE SOLUTION FROM THE CAP IS RELEASED INTO THE TUBE. FIRMLY TIGHTEN CAP TO ASSURE THE CAP AND TUBE IS COMPLETELY SEALED.

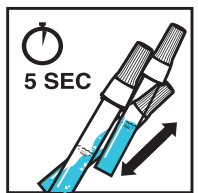

STEP 4: SHAKE THE TUBE FOR AT LEAST FIVE SECONDS.

THIS WILL ENSURE YOUR SAMPLE MIXES THOROUGHLY WITH THE STABILIZING SOLUTION.



STEP 5: PLACE THE TUBE INTO BIOHAZARD BAG AND INSERT INTO THE RETURN BAG.



STEP 6: PLACE BARCODE STICKER ON THE RETURN BAG.